

See Through Type Sight Flow

Model: KSG2

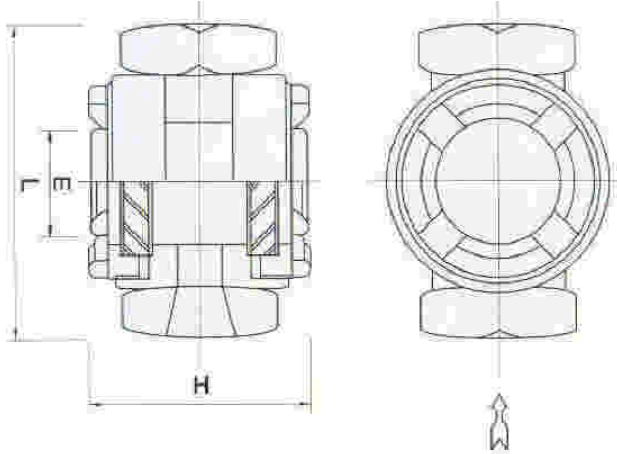

SPECIFICATION

Max. Pressure: 10 – 30 bar
 Max. Temperature: 300°C
 Glass: Tempered Glass
 Connection: BSPF or NPTF

DIMENSIONS

Size A(")	L	H	E
15(1/2)	100	73	40
20(3/4)	100	73	40
25(1)	120	73	40
32(1-1/4)	120	73	40
40(1-1/2)	145	120	65
50(2)	160	135	80

MATERIAL

Body
FC20(Cast Iron)
SCS13(Cast Stainless Steel)
SCS14(Cast Stainless Steel)
SCPH2(Cast Steel)

Model: KSG3

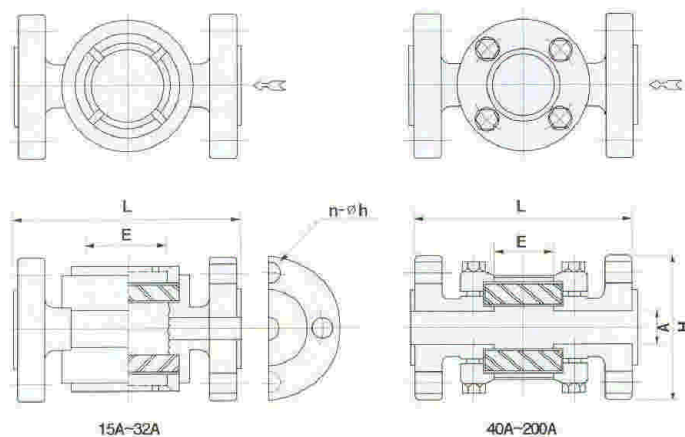

SPECIFICATION

Connections: Flanged to DIN or ANSI spec
 Max. Pressure: 10 – 30 bar
 Max. Temperature: 100°C~300°C
 Glass: Tempered Glass

DIMENSIONS

Size A(")	L	H	E
15(1/2)	150	82	40
20(3/4)	150	82	40
25(1)	170	90	40
32(1-1/4)	170	114	40
40(1-1/2)	200	114	65
50(2)	220	132	75
65(2-1/2)	220	132	75
80(3)	270	176	105
100(4)	320	206	130
125(5)	380	250	170
150(6)	420	281	200
200(8)	500	343	260

MATERIALS

Body
FC20(Cast Iron)
SCS13(Cast Stainless Steel)
SCS14(Cast Stainless Steel)
SCPH2(Cast Steel)